



Keith  
Ashton

St. Stephens Crescent,  
Brentwood



## 18 ST. STEPHENS CRESCENT Brentwood, CMI 3 2AU

\*\*Guide Price £400,000 - £415,000\*\* We are delighted to present this beautifully maintained three-bedroom family home, perfectly positioned within the highly sought-after catchment area for the renowned St Martins Secondary School.

Well-presented throughout, the property features a bright and spacious open-plan lounge and dining area, a modern, well-equipped kitchen, three generously sized bedrooms, and a contemporary shower room. Ideally located just 1.5 miles from Brentwood Station, offering excellent transport connections into London and beyond, this home combines comfort, style, and convenience – an ideal choice for modern family living.

- THREE BEDROOM FAMILY HOME
- NO ONWARD CHAIN

- WELL PRESENTED THROUGHOUT
- ST MARTINS CATCHMENT AREA

- SOUTH FACING GARDEN
- OPPORTUNITY TO EXTEND (STPP)

- OFF-STREET PARKING
- 1.5 MILES FROM BRENTWOOD STATION

Guide Price £400,000 - £415,000



## Description

The home welcomes you with a bright entrance hall that leads seamlessly into a well-designed kitchen, featuring a range of eye and base level units, contrasting worktops, and direct access to the rear garden. At the heart of the property lies a spacious open-plan lounge and dining area, filled with natural light from a charming bay window to the front and French doors opening to the rear. This inviting space provides the perfect setting for both relaxed family living and entertaining.

Upstairs, the first-floor landing leads to three generously sized bedrooms, all served by a sleek, contemporary shower room.

Outside, the south-facing rear garden begins with a paved patio, ideal for outdoor dining, and extends to a neatly maintained lawn framed by mature shrubs, with practical storage sheds and a summerhouse with further seating area to the base of the garden. To the front, a block-paved driveway offers convenient off-street parking.



GROUND FLOOR  
365 sq.ft. (33.9 sq.m.) approx.

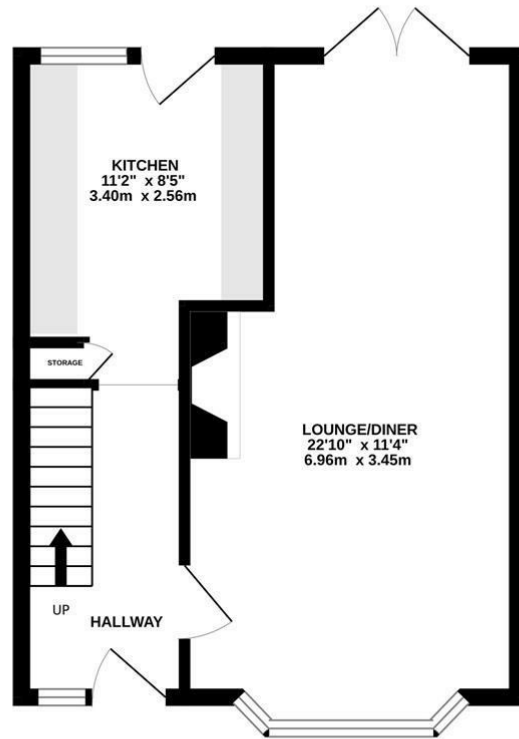

1ST FLOOR  
416 sq.ft. (38.6 sq.m.) approx.

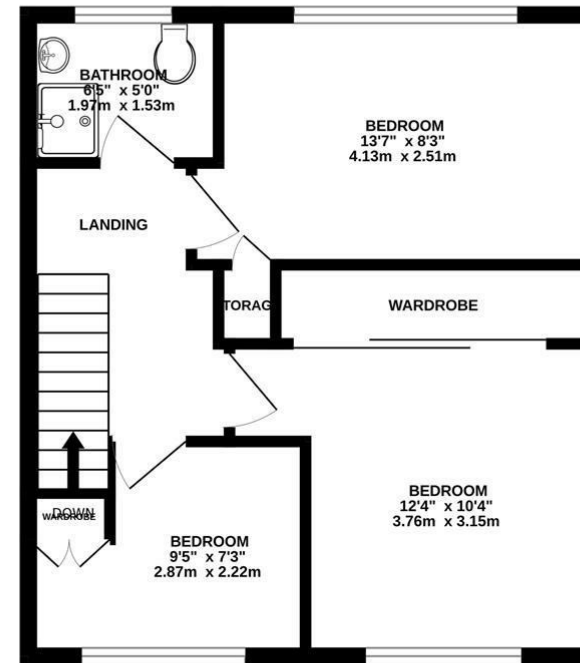

TOTAL FLOOR AREA : 781 sq.ft. (72.6 sq.m.) approx.  
Measurements are approximate. Not to scale. Illustrative purposes only  
Made with Metropix ©2025

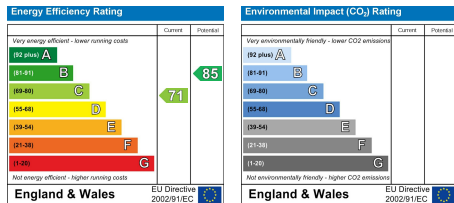

**SERVICES:**

Local Authority: Brentwood  
Council tax band: C  
Post code: CM13 2AU

**VIEWING:**

Strictly by prior arrangement with Keith Ashton Estate Agents

**OPENING HOURS:**

Monday to Friday: 8.45AM - 6.30PM | Saturdays: 9AM - 5.30PM | Sundays: 10AM - 2PM

**MORTGAGE INFORMATION:**

We offer the additional facility of an in-house Independent Financial Adviser who will access all mortgage lenders with the purpose of providing you with the benefit of choice. For quotations or comparables please call 01277 260858 or visit our interactive website at [www.mortgagebusiness.net](http://www.mortgagebusiness.net)



We the Agent have not tested any apparatus, fittings or services for this property. The plot size is intended merely as a guide and has not been officially measured or verified by the Agent. Photographs are for illustration only and may depict items which are not for sale or included in the sale of the property. As part of the service we offer we may recommend ancillary services to you which we believe may help you with your property transaction. We wish to make you aware, that should you decide to use these services we will receive a referral fee. For full and detailed information please visit 'terms and conditions' on our website [www.keithashton.co.uk](http://www.keithashton.co.uk)

Brentwood  
Tel. 01277 260858

Village Office  
Tel. 01277 375757

Lettings Office  
Tel. 01277 202200

Explore more @ [www.keithashton.co.uk](http://www.keithashton.co.uk)